

# How to integrate with Mailercloud

Last Modified on 07/01/2026 1:01 pm EDT

[Mailercloud](#) gives you the best email marketing tools and empowers you to flourish your business plans with user-friendly, automated, and targeted campaigns.

Digioh's Mailercloud integration allows you to capture leads with pop-up forms, pop-ups, surveys, and quizzes, then pass that data to Mailercloud as contacts in real-time.

If you are setting up a Digioh integration by yourself, we first recommend reading about [Digioh Integration Basics](#).

Follow these instructions to set up a Mailercloud integration.

## Steps

### 1: Log in to Digioh

### 2: Add a New Integration

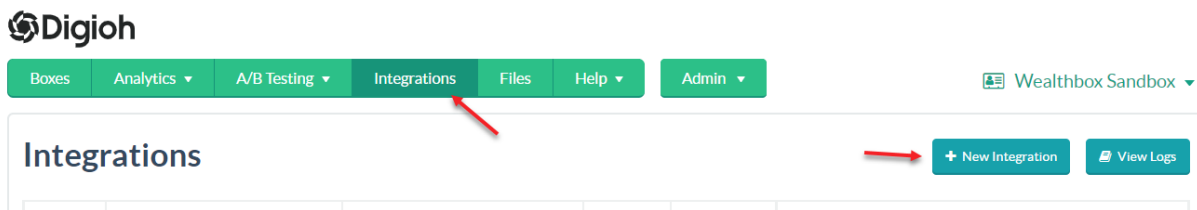

### 2: Select Mailercloud in Integration Dropdown

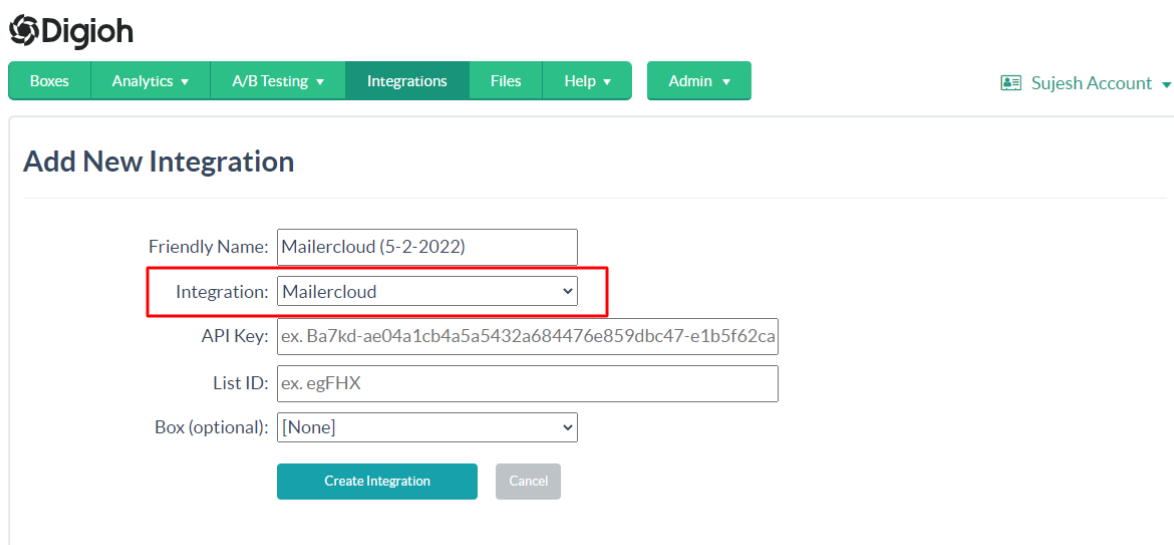

### 5: Enter Mailercloud API in API Key Field

### Add New Integration

Friendly Name:

Integration:

API Key:

List ID:

Box (optional):

For Mailercloud API key.

1- Login to your Mailercloud account.

2- Click on the profile icon

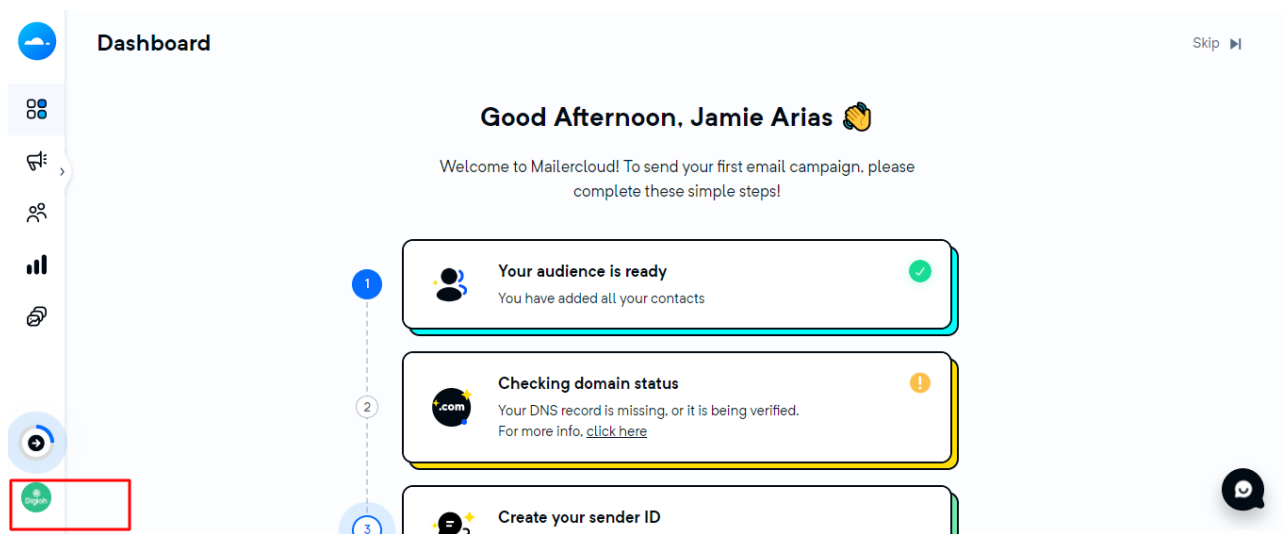

3- Then click on the Account menu link

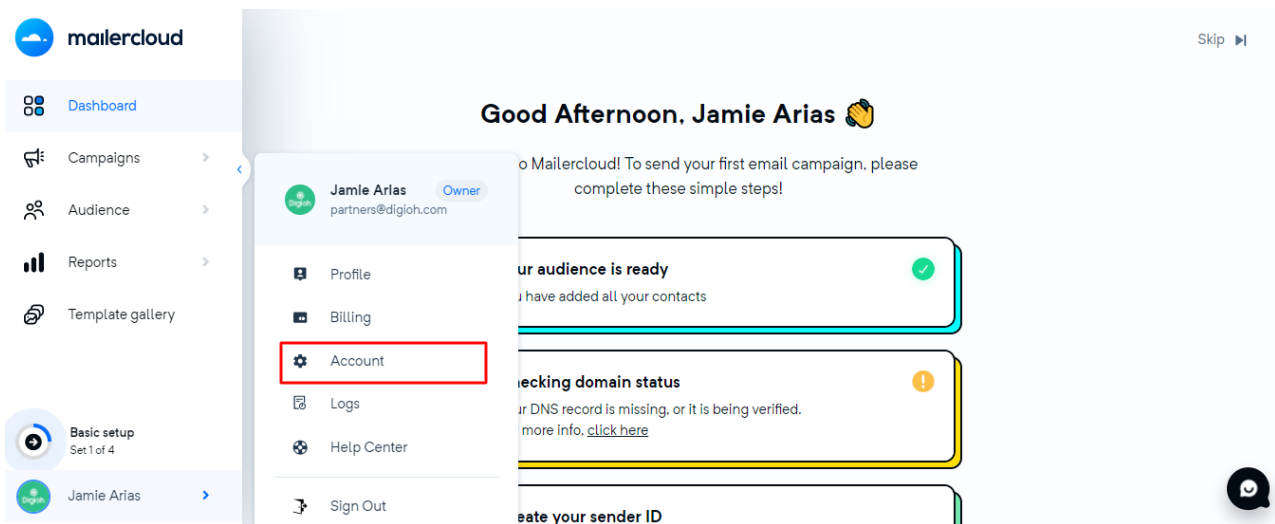

4- On the Account page hover on integrations and click on API integrations.

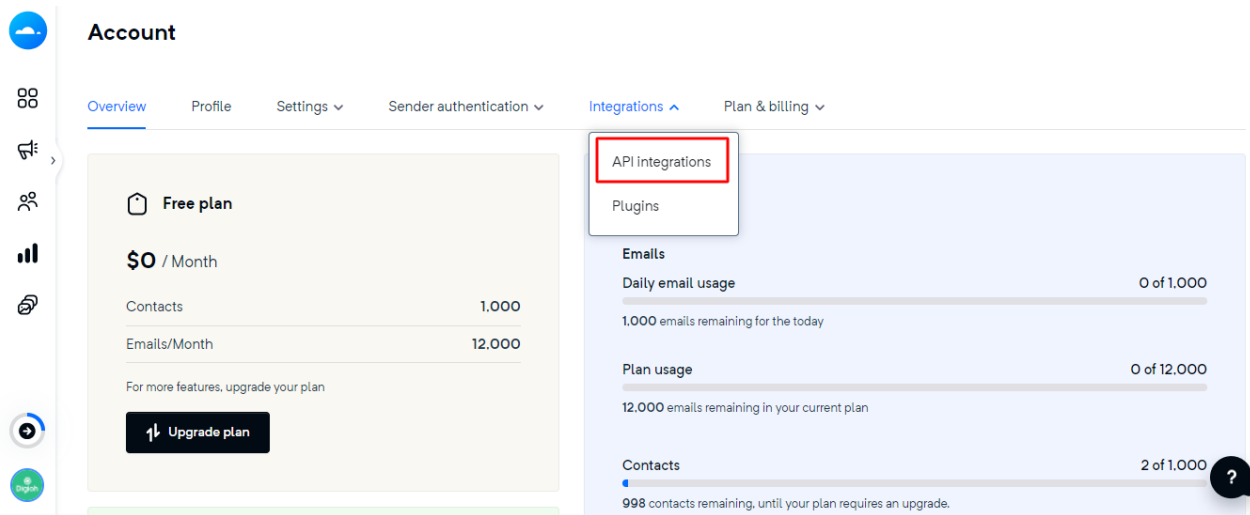

5- On the API integrations screen click on Create API Key button.

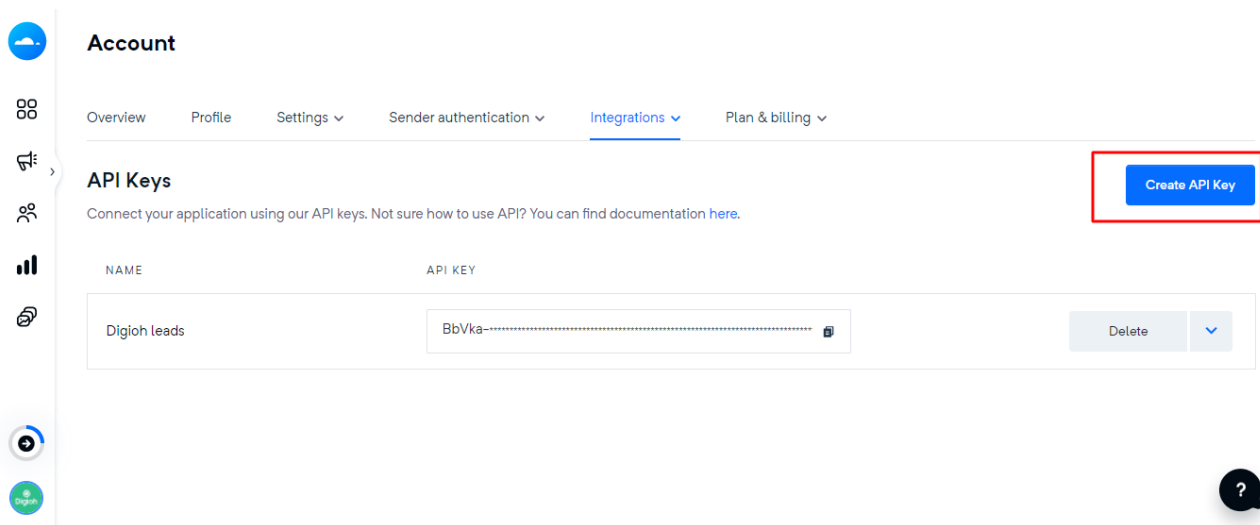

6- Enter the name of the API Key and Click on Generate Key button.

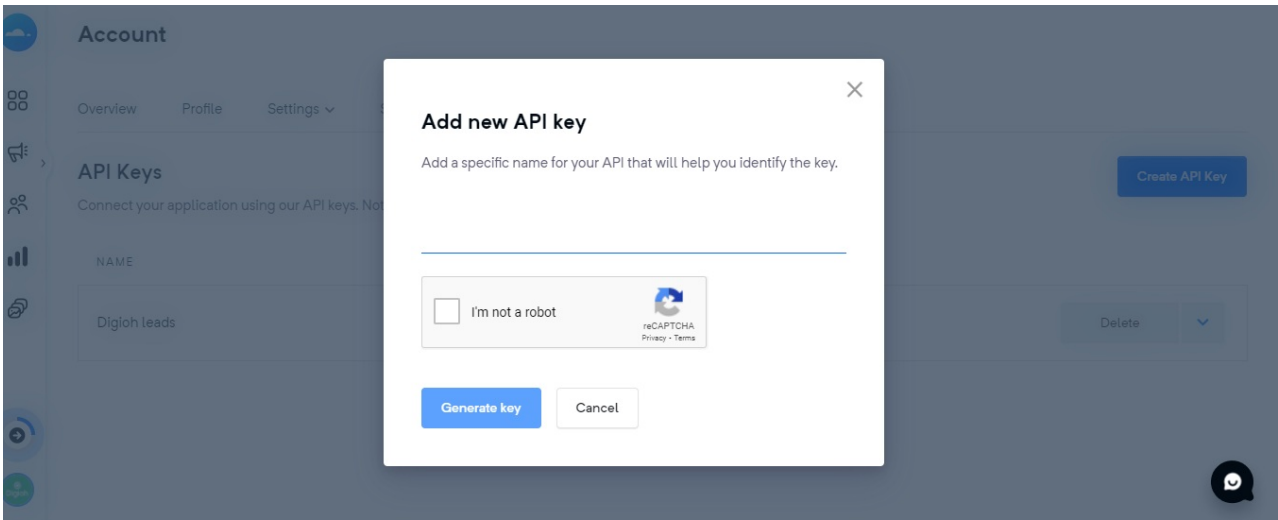

8- Copy the API key and place it in the API key Field.

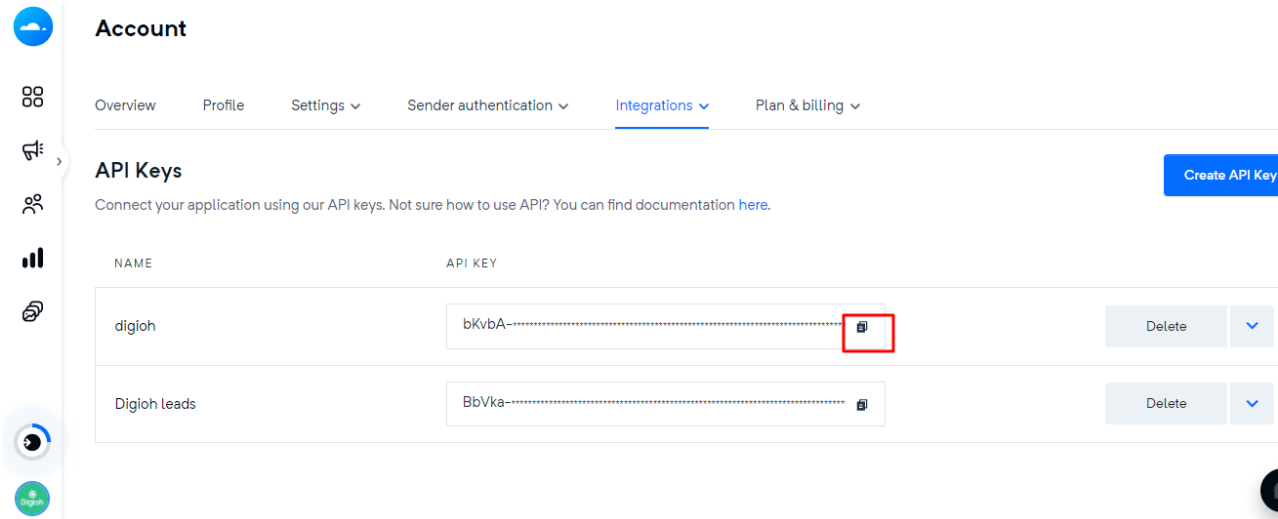

## Step 5: Add Mailercloud List ID in List ID field

## Add New Integration

Friendly Name:

Integration:

API Key:

List ID:

Box (optional):

## 6: Select Campaign

Select the campaign and click Create Integration.

**Note: We are passing the following JSON payload by default. If you want to add custom fields to Mailercloud Continue to step 7.**

```
{
  "city": "[CITY]",
  "country": "[COUNTRY]",
  "email": "[EMAIL]",
  "last_name": "[LAST_NAME]",
  "list_id": "UjdZK",
  "name": "[FIRST_NAME] [LAST_NAME]",
  "contact_type": "active"
}
```

## 7: Configure Advanced Integration Settings

On Integrations Page click on the Advanced Link for Mailercloud integration.

Success! You have successfully deleted your integration. ✕

## Integrations

[+ New Integration](#) [View Logs](#)

ID	Name	Type	Actions
61022	Mailercloud (5-2-2022)	Custom	Update <b>Advanced</b> Duplicate   Delete <span>✔</span>

In Raw Data to Send (merge variables will be replaced) fieldSet up your payload.

```
{
  "city": "[CITY]",
  "country": "[COUNTRY]",
  "department": "computer science",
  "email": "[EMAIL]",
  "industry": "IT",
  "job_title": "SE",
  "last_name": "[LAST_NAME]",
  "list_id": "egFHX",
  "name": "[FIRST_NAME] [LAST_NAME]",
  "contact_type": "active"
}
```

For creating a contact, email and list id are required. Modify the fields as needed.

You can also pass custom fields like custom\_1, custom\_2, custom\_3, etc to Mailercloud. First, create the custom field in the Mailercloud (Visit [Mailercloud custom properties documentation](#) for creating the custom property in Mailercloud). Then, add the field name and its merge tag value to the RAW JSON section. Check the example payload below.

```
{
  "city": "string",
  "country": "string",
  "custom_fields": {
    "enc_id1": "string",
    "enc_id2": 0
  },
  "department": "string",
  "email": "string",
  "industry": "string",
  "job_title": "string",
  "last_name": "string",
  "lead_source": "string",
  "list_id": "string",
  "middle_name": "string",
  "name": "string",
  "organization": "string",
  "phone": "string",
  "salary": 0,
  "state": "string",
  "zip": "string",
  "contact_type": "active"
}'
```

Note: **enc\_id1** and **enc\_id2** are Mailercloud custom fields.

For additional Campaign metadata That Digioh can push, [see this list](#)

That's all Your Mailercloud contact API integration is ready to go!

---